



Donovan Saunders

Candidate Property Practitioner
Registered with PPRA
(FFC 121 151 8)

0743713355

donovan@newpointproperty.co.za

Contact Head Office

010 0354431

Office 40A
Eden Meadows Complex
1 Van Riebeeck Avenue
Greenstone
1609

NEW



Web Ref DS24850PTL

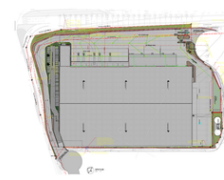

R2,360,750 pm

Gross Monthly Rental R2,360,750 Excl. VAT

10 10

UNDER CONSTRUCTION! New A-grade 24850sqm industrial warehouse in Glen Marais!

This state-of-the-art 24,850sqm industrial warehouse, currently under construction and set for completion in August 2025, presents an exceptional opportunity for logistics, distribution, and storage operations. Strategically located in the fast-developing Glen Marais precinct, the facility offers quick and easy access to major highways and O.R. Tambo International Airport, ensuring seamless connectivity for businesses that require efficient transportation links. Designed to meet the highest modern industrial standards, the warehouse features multiple dock levelers and large roller shutter doors, enabling smooth loading and offloading processes.

The warehouse boasts excellent internal height, allowing for maximum racking efficiency, while a full sprinkler system ensures fire

Features

Zoning Industrial

Interior

Power 3 Phase Yes

Exterior

Security Yes
Covered Parking Bays 10
Open Parking Bays 10

Sizes

Floor Size 24,850m²
Land Size 47,222m²
Building Height 15m

